

The selection is detailed on page 3



DPT50

Differential Pressure Transmitter

Working principle

The working medium pressure is transmitted through the standard process connector and then affects the internal pressure sensor element. Internal electronics convert raw transmitter signals into filtered, amplified, temperature compensated and standardized signals such as 4...20mA signal, etc. The output signal is transmitted to the next unit for signal processing via standardized connectors or cables.

Product application

Fans and blowers, filters
Furnace body ventilation, clean room pressure
Smoke mask control
Oven pressurization, medical equipment

Product description

DPT50 differential pressure meter adopts high precision transmitter and digital technology, easy installation, liquid crystal display, clear and accurate reading. Suitable for measuring the pressure of fans and blowers, filter resistance, wind speed, furnace body ventilation, orifice plate, medical equipment and other pressure difference; Optional switching output relays or NPN or PNP versions for flexible external control of other devices.

Product description

Input non-polarity: The input voltage source is connected in both positive and negative directions
Selected excellent materials, using flame retardant ABS injection molding shell, with good impact resistance, heat resistance and heat resistance
Measuring range :0~±100Pa/0~±1,000Pa/0~±10,000Pa
Accuracy :±1.0%FS
Multiple pressure units can be switched
Intuitive large display LCD
Manual key differential zero calibration
Manually press keys to restore factory Settings
View the lowest and highest pressure readings
Field programming digital damping filtering degree
The built-in buzzer provides audible and visual alarm, and can be programmed to alarm the pressure value on site
Adjustable range of pressure values for upper and lower limits of switching output type (DPT51 series only)



Technical parameter

precision	+1.0%FS	
Pressure unit	Pa, kPa, mbar, mmHG, inWC, mmWC	
Power supply	Input voltage is 10~30VAC/VDC, 24VDC adapter (3.5×1.35mm) power supply; Internal 9V battery (6F22 battery) powered (DPT50 only)	
Power dissipation	0.75 W or less	
Measuring medium	Air and neutral media	
Service temperature	- 10 ~ + 60 °C	
Storage temperature	- 10 ~ + 70 °C	
Allowable overvoltage	range	Overload capacity
	-1000~+1000Pa	-15,000~+15,000Pa
	-10,000~+10,000Pa	-150,000~+150,000Pa
	-100~+100Pa	-4500~+4500Pa

Connection mode

DPT50 wiring

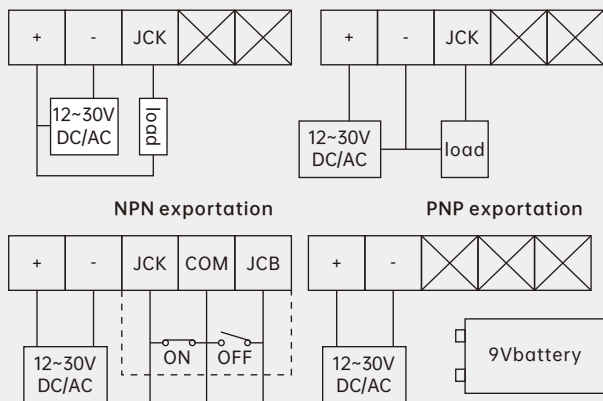

DPT51 wiring

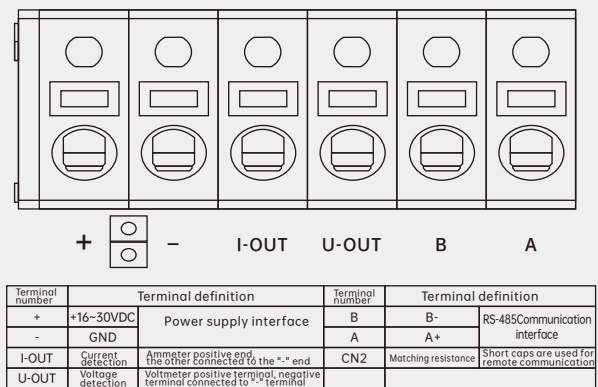

Size mm

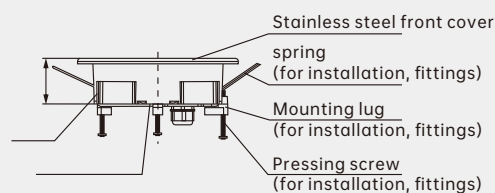
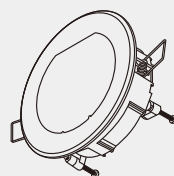
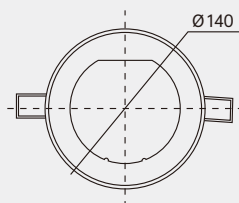
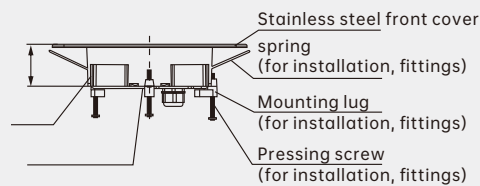
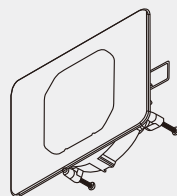
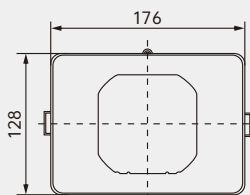

DPT50-Selection composition

 Selection example **DPT50**

A	M	H	S	U
1	2	3	4	5

1.Measuring range	A	-1,000~1,000Pa
	B	-10,000~10,000Pa
	C	-100~100Pa
2.Precision class	M	±1.0%FS
3.Output signal	H	Relay Output
	I	NPN Output
	J	PNP Output
	K	4~20mA and 0~5V/0~10V (simultaneous output)
	L	4~20mA/ Three-wire system
	M	0~10V/ three wire system
	N	0~5V/ Three wire system
	O	RS-485 Communication
	P	0~10V and RS-485 communication
	Q	0~ 5V and RS-485 communication
	R	4~20mA and RS-485 communication
4.Intake mode	S	Front panel intake
	T	Rear panel air intake
5.Mounting panel	U	Plastic panel (round)
	V	Stainless steel panel (square)

Instructions:

DPT50 differential pressure transmitter, measuring range: -1,000~1,000Pa, accuracy class ±1.0%FS, relay output, front panel intake, plastic panel.

Product Certification

Compliance and approval; Rodewieg pressure gauges meet key standards and certifications for process measurement technology; Thus guaranteeing the highest reliability in such Settings;