

The selection is detailed on page 4



# TH10

## Temperature Transmitter

### Product application

It can be widely used in HVAC, building, storage and other places that need to detect temperature

### Product description

TH10 series temperature transmitter is a transmitter specially designed for industrial applications, which is specially designed for lightning surge, electrostatic discharge, group pulse voltage resistance, etc., and has strong anti-interference ability. There are five installation methods, including wall hanging, air pipe/water pipe, split body and clamp, and three output modes of current, voltage and thermal resistance are optional. The field installation ability is strong, and the spring screw/terminal design is suitable for quick installation. It can be widely used in HVAC, building, storage and other places that need to detect temperature.

### Functional characteristics

Up to 5 installation and output options are available

New industrial appearance quick installation design, suitable for quick installation and deployment

Imported Heraeus A-class sensor, high precision, fast response, low temperature drift

With excellent anti-interference ability and protection function, CE certification, IP65, RoHS



Product parameter

Sensor	High precision thermal resistance, see selection table (resistance output type) /PT1000, Class A (analog output type)	
Exportation	Resistance value, see the selection table and thermal resistance index table / 4~20mA or 0~10VDC,0~5VDC	
Thermal resistance	See selection table and thermal resistance index table	
Precision	Typical 0.2~0.5°C@0/25°C, see the selection table/soil 0.3 °C@25°C, see the accuracy curve for details	
Power source	Voltage type 15~35VDC/24VAC±20%	Current mode 18.5~35VDC (RL=500Ω) 8.5~35VDC (RL=0Ω)
Output load	(Analog output type): ≤500Ω(current type), ≥2KΩ(0~5V), ≥3KΩ(0~10V)	
Housing material	PC housing, stainless steel probe (6MM) and casing	
Working environment	-40~70°C, 0~95%RH(non-condensing)	
Class of protection	IP65	

Temperature accuracy curve

Temperature accuracy curve (analog output type)

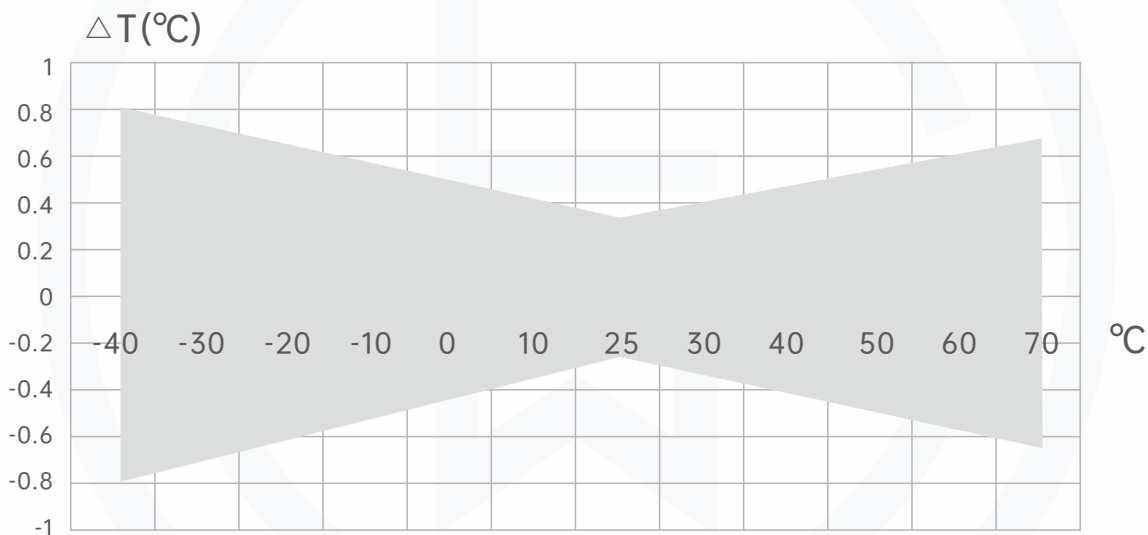

Size specification

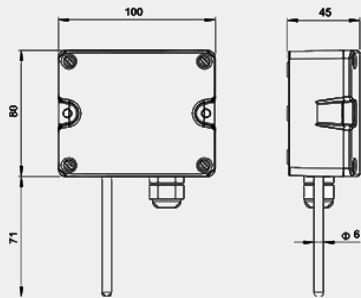

TH10-A wall mounted dimensions

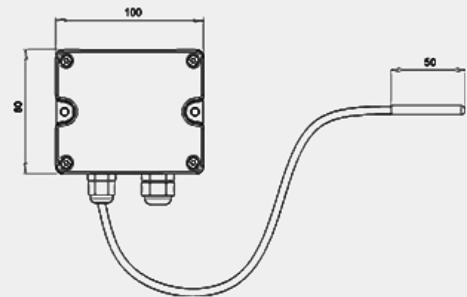

TH10-D sub-body outline size diagram

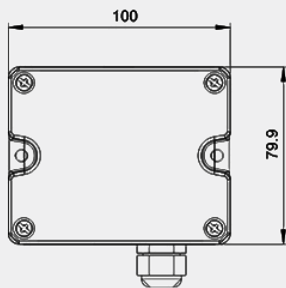

TH10-B pipe type dimensions

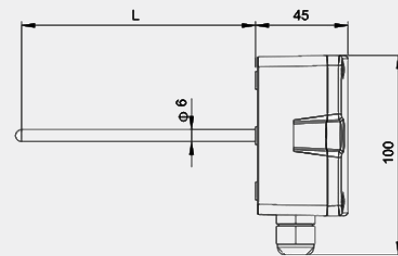

TH10-C pipe type dimensions

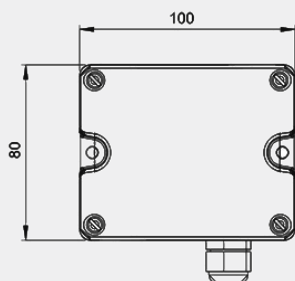

TH10-E clamp type dimensions

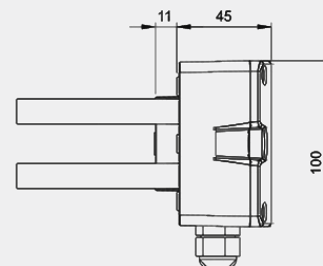

TH10-F clamp type dimensions



## TH10-Selection composition

Selection example TH10



1.Product model	A	Wall-mounted temperature transmitter
	B	Air tube type temperature transmitter
	C	Water tube type temperature transmitter
	D	Split type temperature transmitter
	E	Clamp-type temperature transmitter
2.Temperature output	G	0~10VDC(Three-wire)
	H	4~20mA(Second line)
	I	0~5VDC(Three-wire)
	O	PT1000, ±0.2°C@0°C
	P	PT100, ±0.2°C@0°C
	Q	NTC20K, ±0.3°C@25°C
	R	NTC10K,±0.3°C@25°C
3.Temperature range	J	0-50°C
	K	-20-60°C
	L	There is no
	T()	Other scope
4.Probe length	N	65mm
	O	100mm
	X	150mm
	Y	200mm
	T()	Other length

## Instructions:

TH10 wall mounted temperature transmitter temperature output 0~10VDC(three wire) temperature range 0~ 50°C, probe length 65mm.

## Product certification

Compliance and approval; Ludwig temperature transmitters meet key standards and certifications for process measurement technology; Thus guaranteeing the highest reliability in such Settings;